

aerospace
climate control
electromechanical
filtration
fluid & gas handling
hydraulics
pneumatics
process control
sealing & shielding



Parker Pneumatic

A complete range of system components

Catalogue PDE2600PNUK February 2016

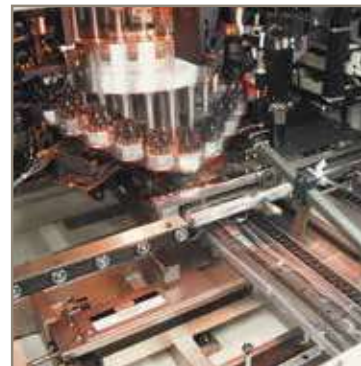

ENGINEERING YOUR SUCCESS.

Compact 3/2 normally closed metal bodied valves with push-in air connections. Designed for the process duty cycle with high durability. Ideal for the process or packaging industry.

- High durability
- Very good repeat accuracy
- Design for process duty cycle
- Push-in connection
- Versatile and easily maintained
- Miniature size

 **For ATEX specific products contact Sales Office**





Operating information

Working pressure; PXC-M	3 to 8 bar		
Working temperature	-15 °C to +60 °C		
	PXC-M111	PXC-M121	PXC-M521
Flow (Qmax):	60 l/min	85 l/min	250 l/min
			PXC-M601
			250 l/min
For more information see www.parker.com/euro_pneumatic			

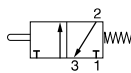
Bore Ø1,5 mm, flow 60 NI/min

Symbol	Actuator	Return at 6 bar, N	Operating forces	Order code
	Steel plunger	Spring	11	PXC-M111

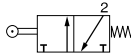
Bore Ø1,5 mm, flow 85 NI/min

Symbol	Actuator	Return at 6 bar, N	Operating forces	Order code
	Plastic roller	Spring	4,5	PXC-M121
	Steel roller	Spring	4,5	PXC-M131

Bore Ø2,5 mm, flow 250 NI/min

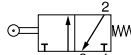
Symbol	Actuator	Return at 6 bar, N	Operating forces	Order code
	Plastic roller	Spring	7	PXC-M521

3/2 compact limit switches -

With Ø4mm Push-in connections with pipeable exhaust port

Bore Ø2,5mm, flow 250 NI/min - With plunger head

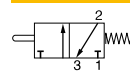
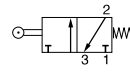
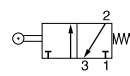
Symbol	Actuator	Return at 6 bar, N	Operating forces	Order code
	Steel plunger	Spring	24	PXC-M601A110
	Steel roller plunger	Spring	24	PXC-M601A102
	90° Steel roller plunger	Spring	24	PXC-M601A103

Dimensions, Limit switches, Series PXC

All dimensions in mm unless otherwise stated

3/2 miniature limit switches

PXC-M111 PXC-Z12 PXC-Z11

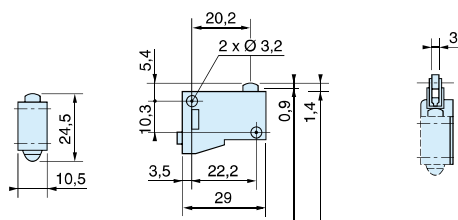

PXC-M121 - PXC-M131

PXC-M521

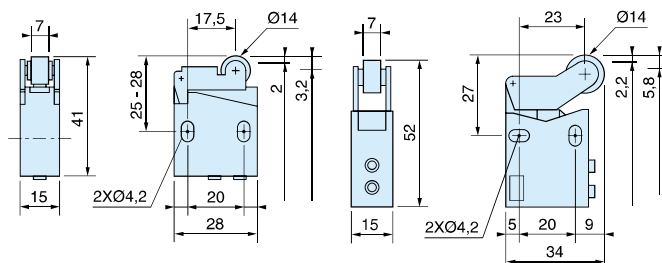

3/2 compact limit switches

PXC-M601A102 PXC-M601A103

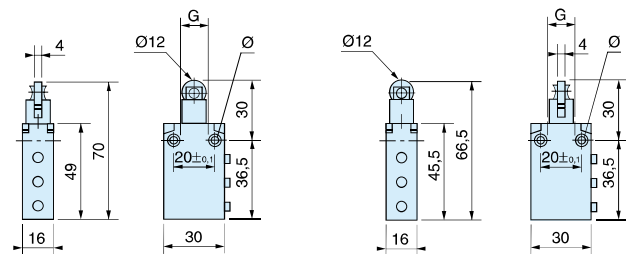

PXC-M601A110

